

DE/RU/EN/JP/IT/ES

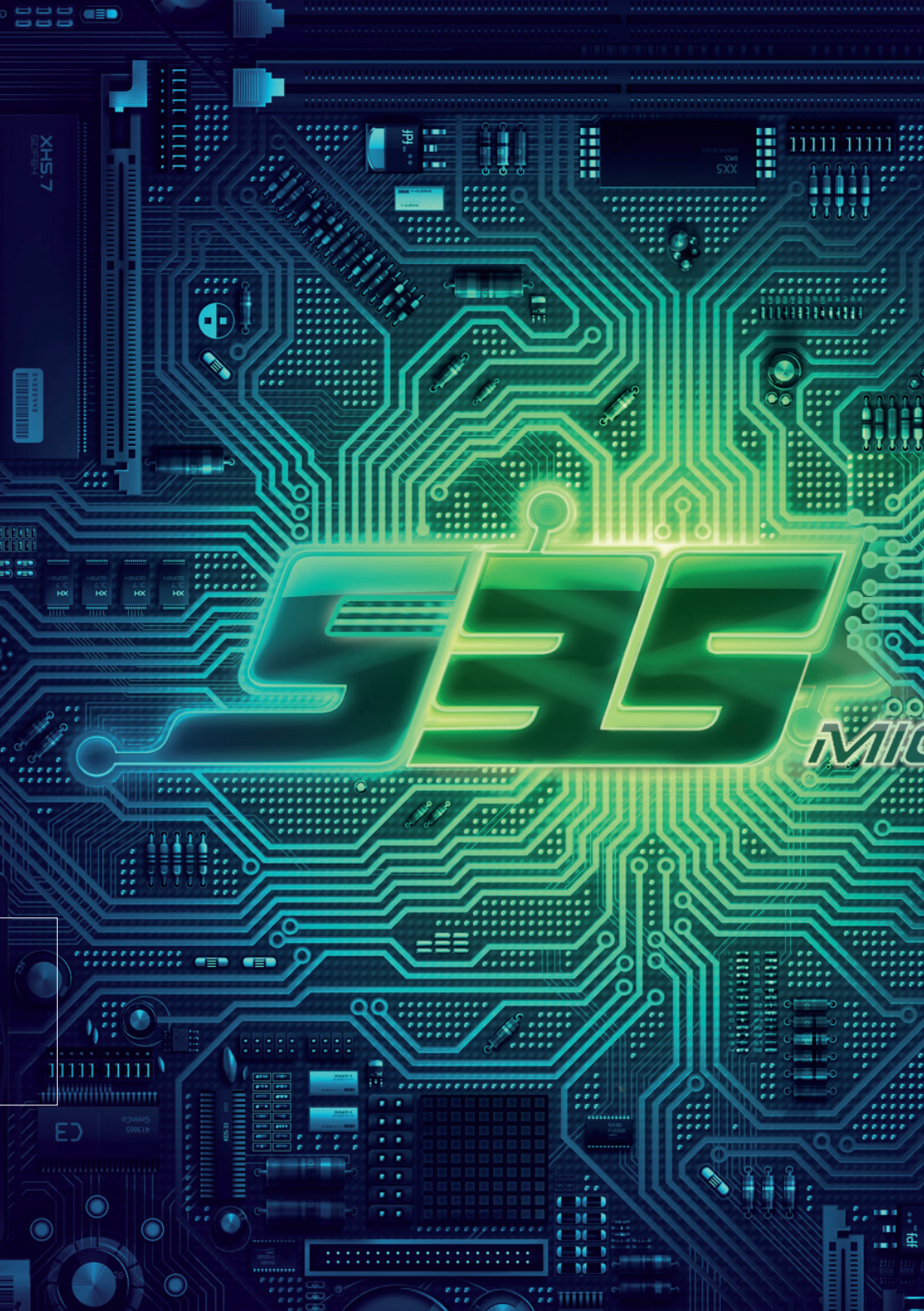

OPERATING INSTRUCTIONS
S35 micro





XHS-7

BARCODE
EASEREF

tdf

5XX

HXC HXC HXC HXC

MIC

AT8655
STANLEY

fpj

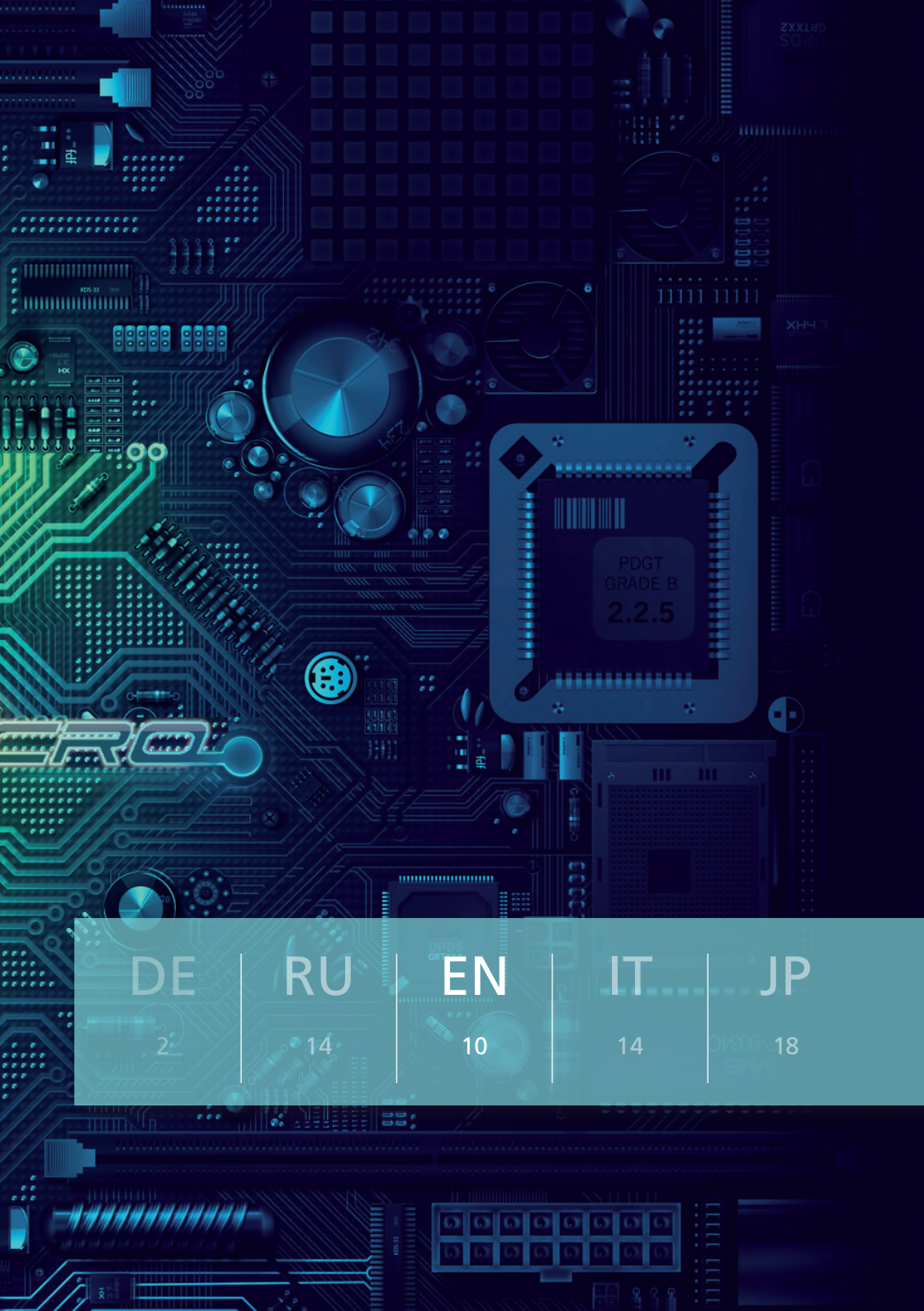

DE

2

RU

14

EN

10

IT

14

JP

18

Technical data

Measurements:	290 x 123 x 250mm
Extent of supply:	Tuner-amplifier, micro engine hand piece, Anther, power cord, operating instructions
Weight:	3900g
Tension:	200-240V (special model 110V)
Guarantee:	24 month

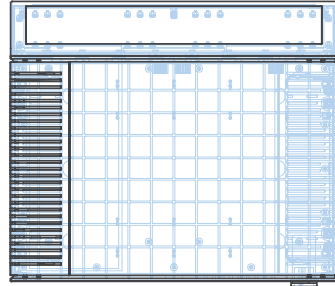
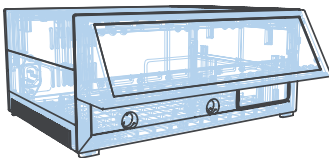
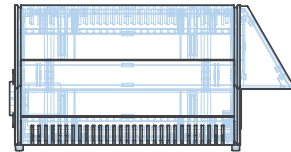
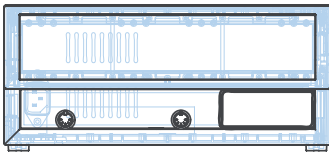

- For reasons of overheating a clearance must be had by at least 30 mm after all sides at the chosen location. The ventilation slits in the device may be locked by no means.
- protecting from humidity
- no liquids may be drawn in with the device
- the device may only be opened by a manufacturer authorized expert
- when opening unauthorized-ly the claim for replacement expires
- the plastic housing may not be cleaned with petrol or chemical cleaning agents. When required use only a soap cloth moistened easily. (Unplugging mains plugs before.)

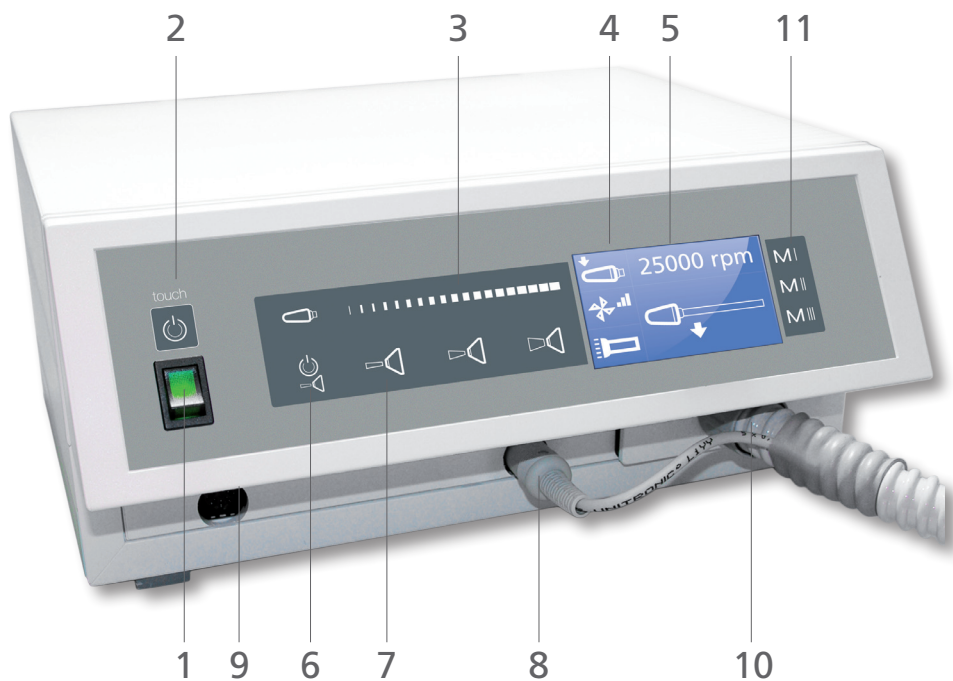

- | | |
|---|--|
| 1. power switch | 6. dust suction stop button |
| 2. equipment start-/ stop button | 7. power increaser dust suction (three steps.) |
| 3. regulator milling cutter speed | 8. socket for engine hand piece |
| 4. double-throw switch:
Milling cutter direction of rotation | 9. connection 12 V/20 W Halogen lamp |
| 5. advertisement milling cutter speed | 10. 10th another container |
| | 11. Memory buttons |

Instructions

- Pushing suction lid with the anther in the anther compartment (11). The plug of the hand piece cable (with the indentation up) plug in to the female plug (8).
- the device to 230 attaching V alternating current by an electrical outlet installed as instructed and switching on power switches (1). (Switch seesaw comes on.)
- You can adjust the milling cutter speed to the desired value in the data entry slider (4). You alter the suction grade by an easy touch about the symbols (7). About the symbol (2) or with the switch at the instructive instrumental piece the device is put into operation. Further functions become touch screen (3) over this, switched, described how below.
- optional business with radio foot switch: By activity of the foot pedal you turn the functions off these shown in the display or. Milling cutter until the stop into this
- Sliding instructive instrumental piece. The milling cutter tension is carried out at this instructive instrumental piece after calling at the engine automatically. The milling cutter can be taken again after interruption of the engine.
- never remove milling cutters a running equipment, danger of injury! Please use milling cutters under no circumstances with a damaged or bent shaft! The shaft diameter must be 2.35 mm. Please at also take the maximum revolutions per minute permitted depending on milling cutter essay into account.

Front sheet



Start/stop instructive instrumental piece with suction



Stop suction

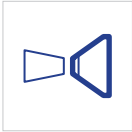
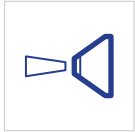
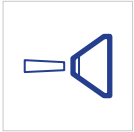

Suction step 1, 2, 3 (Low, mid, high)



Programmable Memory buttons. Pushing „Start/stop button“ and „Memory button“ at the same time, Stores current performance



Slider for milling cutter speed

Touchscreen

Direction of rotation le/ri
push start key to run handpiece again

Suction function max/min
At function „switched off“, no joist visible

Lamp on/off

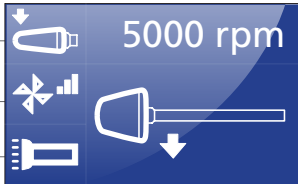

Milling cutter speed
As adjusted/stored
Milling cutter with direction of rotation
Low speed = big milling cutter

Maintenance

Anthers change

Pull out hand piece plugs from socket and pull suction lids out of basic equipment

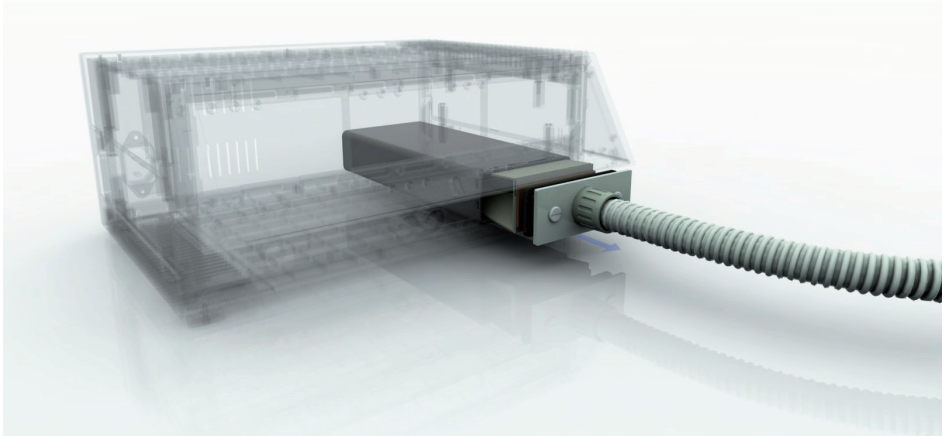

Removing hand piece plugs from the anther

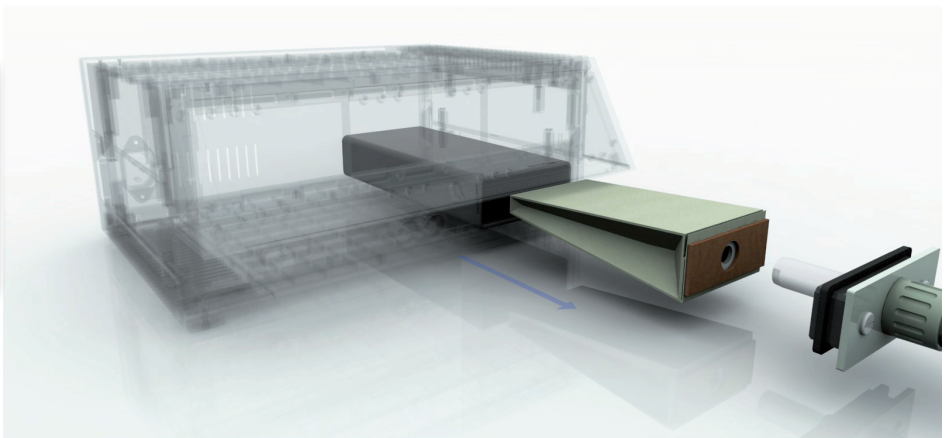

Putting on the anther mount hull a new anther, plugging hand piece plugs into socket and pushing lids into anther containers again.

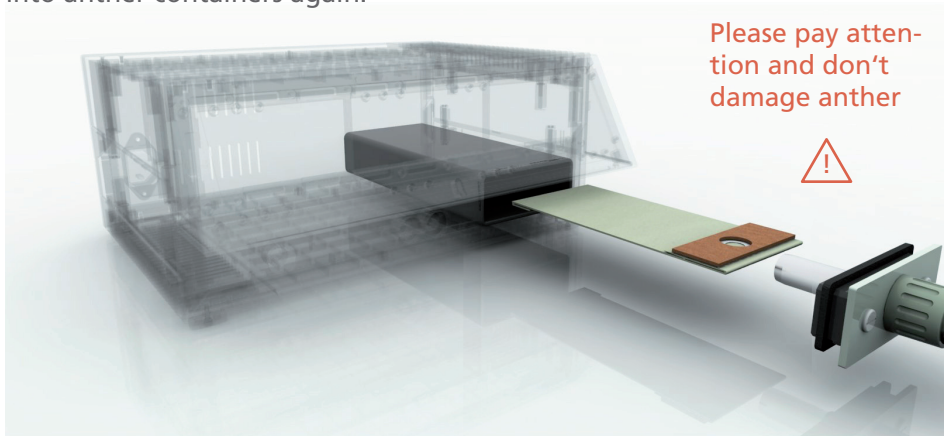

Caution! Do not work without anthers. Change the anther regularly at the latest when this is reported in the display. You spare your device and have always an optimal suction performance.

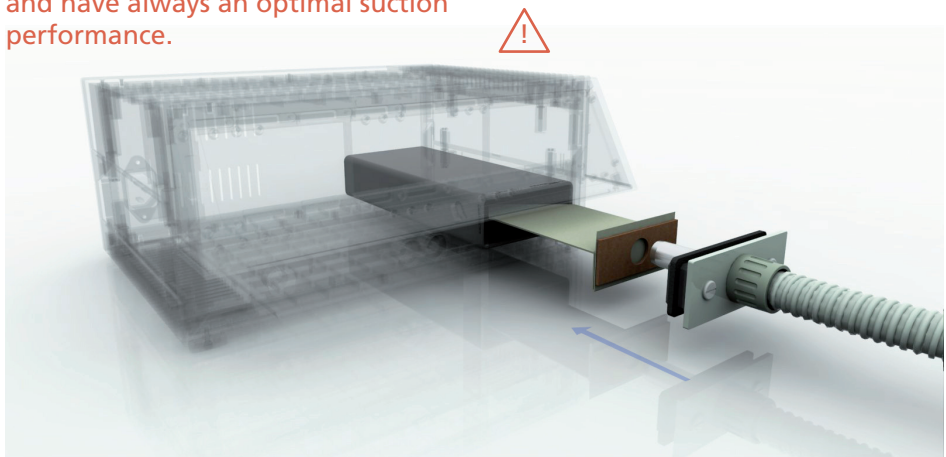

Maintenance

Maintenance and cleaning of the instructive instrumental piece

A regularly maintained instructive instrumental piece guarantees a reliable milling cutter clamping.

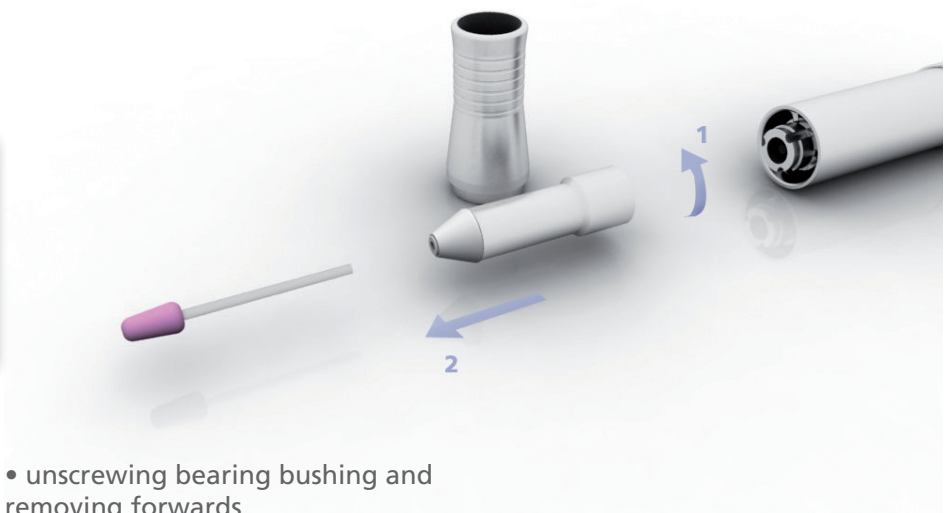
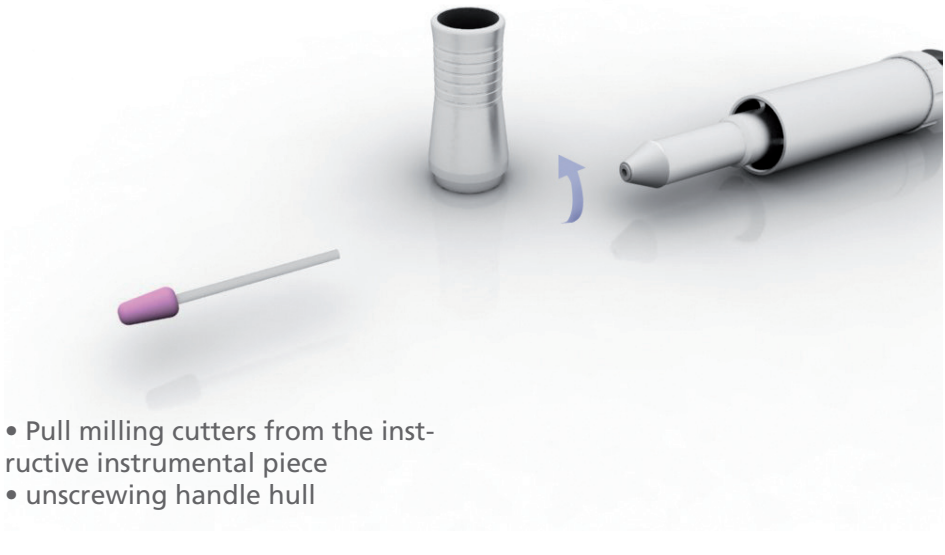

- pushing polygon hull with a milling cutter from the bearing bushing

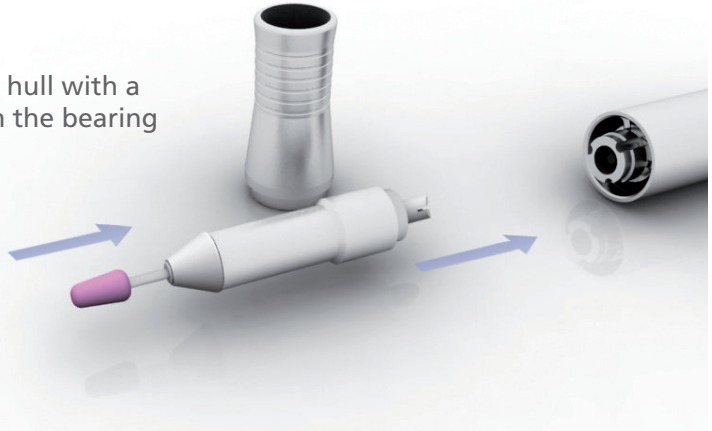

- Pull milling cutters into the collet and pull out collet and tension rollers from the polygon hull

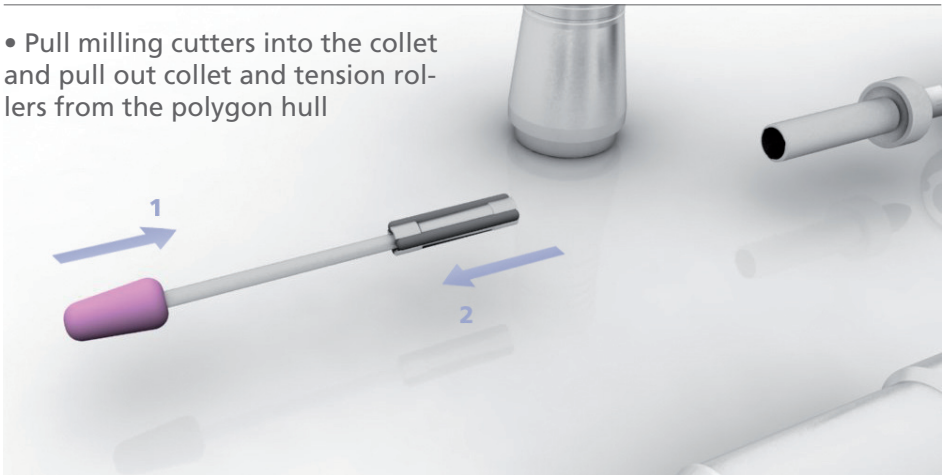

- Clean collet, tension rollers and polygon hull
- the assembly is carried out in a reversed order



Instructive instrumental piece dismantling

Development micro engine

A regularly maintained instructive instrumental piece guarantees a reliable milling cutter clamping.

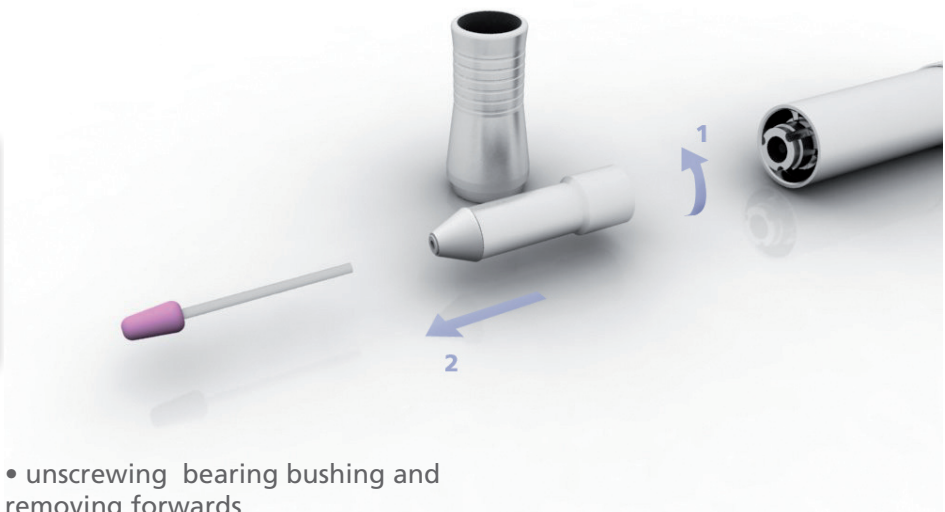
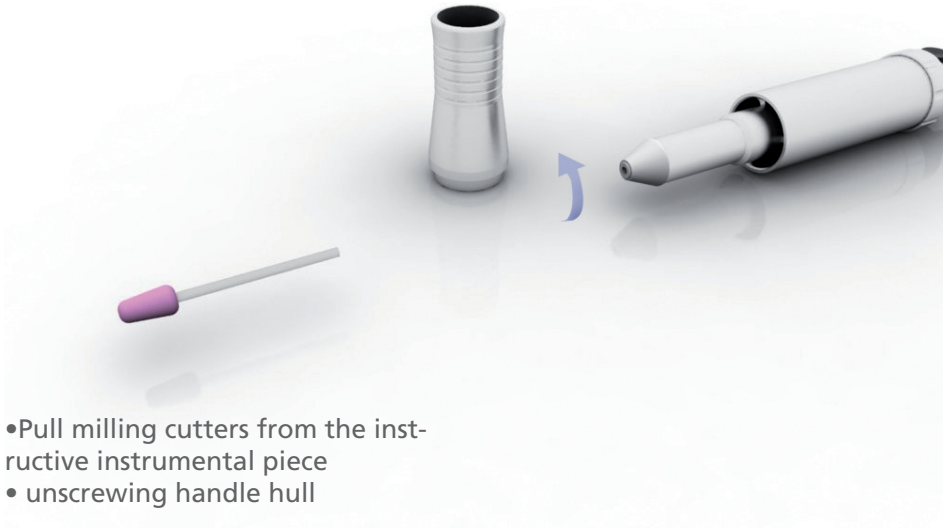

Instructive instrumental piece dismantling

- turn knurled nut (towards left)
- **Caution!** Turning not the synthetic material lid.

By opening wrongly it can damage the connection pin's at the micro engine.



- pulling motor out of the engine hull with the hand piece lid

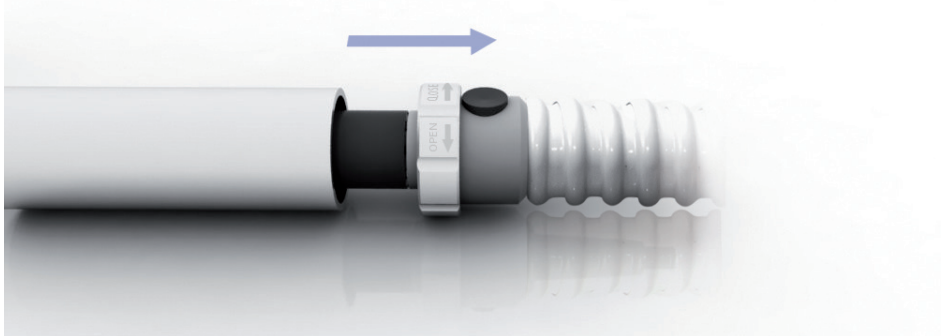

- the engine can be pulled out of the hand piece lid now

Caution! Watch out for the connection pins.



Menu structure

Versioninfo Menu



Illus. 1

Enter the Versioninfo menu by switching on the drill and touching the „ventilator button (illus. 1) „ while the logo is moving to the right on the display.

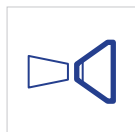

Illus. 2

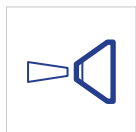

Illus. 3



Illus. 4

In this menu you see the software and hardware version of the LCD operating part, the valve timing and the air controller. Press the ventilator MAX button (illus. 2) to get into the user set-up menu. By pushing a special key sequence (illus. 3 - 7) master set-up menu appears.

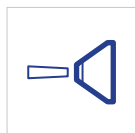

Illus. 5

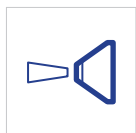

Illus. 6



Illus. 7

VERSIONINFO		
LCD		V0.2
BLCD		003
TOUCH		003
R1	00000	013
R2	00000	013
R3	00000	010
	000	013

- release version LCD display
- release version engine controller
- release version air panel
- running time instructive instr. piece
- running time suction engine
- running time lamp

En

User Setup

40

USER SETUP		
KONTRAST	>	032
LED LIGHT		080
FUNKNO		003
MAXRPM		050
FUNKIO		

In the user set-up menu you can adjust the LCD contrast and the brightness of the backlight

- display contrast
- display brightness
- radiofrequency channel
- max. speed instructive instrumental piece 250 x 100

Additional fault analysis

Clear disturbances by your own

Fault: Milling cutters do not stick	Fault: Milling cutters run irregular
Cause: Collet is dirty Milling cutter shaft in diameter too small	Cause: Milling cutter shaft is crooked
Measure: Collet and clean polygon hull Replacing milling cutters	Measure: Replacing milling cutters

Also notice our extensive accessories and if necessary request our current catalogue



BERCHTOLD GMBH & CO.KG
Freihofstraße 4
D-73730 Esslingen

- _ 0049 (0) 711 / 93 08 17 - 0
- _ mailto@berchtold.info
- _ www.berchtold.info